

# PRICELIST & SPECIFICATION



LOA		17.60 m	57' 9"
Hull length		16.90 m	55' 5"
LWL		16.26 m	53' 4"
Beam		5.30 m	17' 5"
Draft			
shallow keel		2.18 m	7' 2"
L-keel, medium		2.53 m	8' 4"
Displacement			
shallow keel	approx.	23.50 t	51,808 lbs
L-keel, medium	approx.	22.90 t	50,486 lbs
Ballast			
shallow keel	approx.	6.50 t	14,330 lbs
L-keel, medium	approx.	5.90 t	13,007 lbs
Engine Diesel			
standard	approx.	110 PS	110 hp
option	approx.	150 PS	150 hp
Fuel tank	approx.	520 l	137 gal
Fresh water	approx.	770 l	203 gal
CE Certificate		A - 12	
Design		Berret - Racoupeau	
Interior		Berret - Racoupeau	

Mast length above WL	approx.	26.27 m	86' 2"
Total sail area	approx.	151.00 m <sup>2</sup>	1,625 sq ft
Main sail			
standard	approx.	91.00 m <sup>2</sup>	979 sq ft
furling mast	approx.	81.00 m <sup>2</sup>	872 sq ft
Jib	approx.	60.00 m <sup>2</sup>	646 sq ft
Reacher	approx.	112.00 m <sup>2</sup>	1,205 sq ft
Gennaker	approx.	235.00 m <sup>2</sup>	2,529 sq ft

# 590

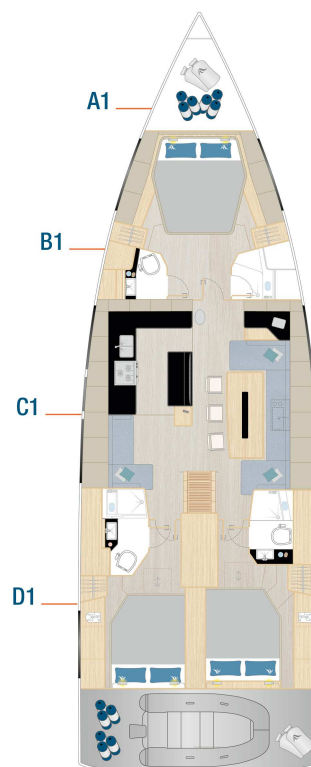
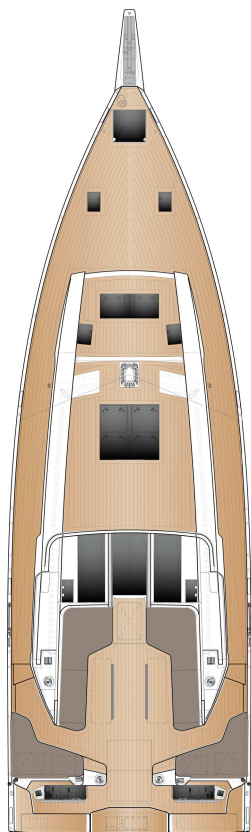

Standard

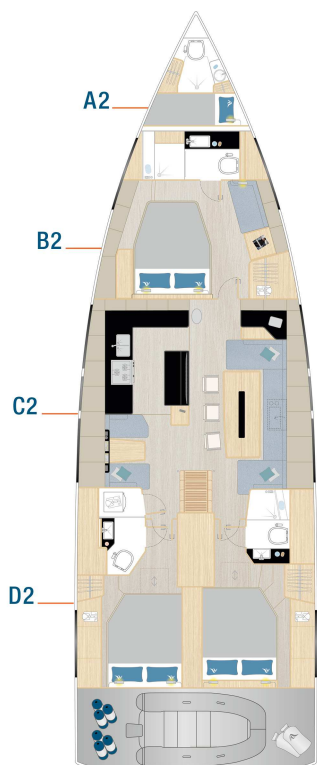

Option

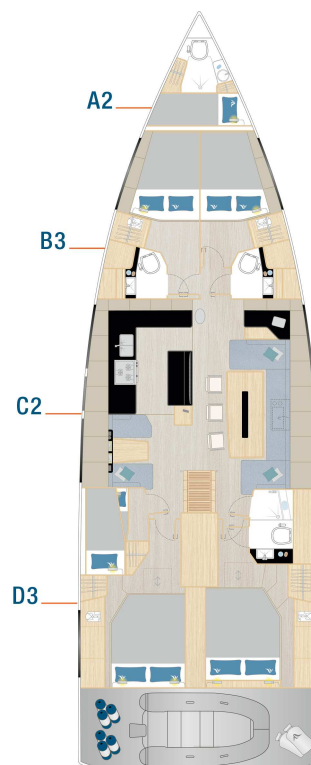

Option

## HULL

- 8 hull windows (4 each side)
- GRP hull, isophthalic gelcoat, colour: Signal White (similar RAL 9003), 1st layer vinyl ester resin with PVC foam core built in vacuum infusion
- Waterline, isophthalic gelcoat, colour: Dark Grey (similar RAL 7043)

## KEEL

- L-keel, cast iron, draft: 2.53 m
- GRP rudder with sea-water resistant aluminium shaft and selfaligning bearings

## LAYOUT & INTERIOR

- A1: Sail locker with extensive storage space
- B1: Master cabin with island double berth, storage space and a head with separate shower stall
- C1: Saloon with full functional island galley and lounge area on port, dining area and multifunction area on starboard
- D1: 2 aft cabins with double berth, storage space and ensuite head with separate shower on each cabin
- 3-burner gas stove with oven, waste bin, 12 V fridge approx. 140 l, double stainless steel sink with mixing tap
- Interior furniture in high quality marine plywood, Satin Varnish
- Hanse companionway closing system
- Saloon table, fixed
- Worktop in galley - Off White

## WOOD (FURNITURE, FLOORBOARD)

- Furniture - Mahogany Style, Satin Varnish
- Cupboard fronts in wood colour
- Floorboard - Acacia
- Floorboard - wooden grating in all showers

## UPHOLSTERY

- Mattresses for all berths
- Upholstery - Monte Carlo, colour: Cream

## DECK & OUTSIDE EQUIPMENT

- GRP deck with antislip surface, isophthalic gelcoat, colour: Signal White (similar RAL 9003), 1st layer vinyl ester resin with balsa sandwich core. Cockpit locker on each side, dinghy garage, stowage for running rigging at helm position, anchor locker at bow.

- Synthetic teak on cockpit bottom (colour selection)
- Synthetic teak on cockpit benches (colour selection)
- Synthetic teak on bathing platform (colour selection)
- Twin wheel steering system
- 2 stainless steel steering wheels with leather cover
- 2 cockpit tables, stainless steel foot with teak tops
- Pulpit and pushpit, stainless steel
- Railing, incl. stanchions and stainless steel wire with gateway stanchion
- Covered halyards and control lines lead to cockpit helmposition, organizers and jammers, 4 retractable mooring cleats, handrails on coach roof
- 2 LEWMAR 65 ST EVO manual halyard winches
- 2 LEWMAR 65 ST EVO manual secondary winches
- Bathing platform, hydraulic fold-out, remote control and swimming ladder
- Anchor windlass, electrical, 1500 W, automatic fuse, remote control with chain counter
- Composite bowsprit with integrated anchor and forestay fitting
- Self tacking jib system
- Mainsheet system
- 7 big and 6 small deck hatches - openable
- 8 deck coach roof windows - openable, glass next to companionway

## RIG & SAILS

- Rig, anodized aluminium, keel stepped, with kicker, standing and running rigging and 2 reefs
- Backstay tensioner, manual
- Manual jib furler
- GRP Targa arch, gelcoat colour: White, with main sheet base
- ELVSTRØM Dacron sails - full battened, main and jib

## NAVIGATION & INSTRUMENTS

- Illuminated compass at each helm station
- Navigation lights - LED

## PROPULSION

- Fuel tank, approx. 520 l
- Engine (Diesel, approx. 110 hp) - saildrive, 3-blade folding propeller

## EQUIPMENT

- 12 V and 230 V electric system with main panels and 230 V shore power and sockets in cabins and heads
- AGM battery set, capacity: 1x 90 Ah + 2x 160 Ah AGM
- Country Version: EU / AUS
- Battery charger
- Manual toilet with sea water flush - cabin layout B1
- 2 manual toilets with sea water flush - cabin layout D1
- Shower unit in cockpit, warm-/coldwater
- LPG gas system, stowage for 2 gas bottles
- Black water system (appr. 85 l per head) with deck extraction and seacock for head, electric and manual bilge pump
- Fresh water system with electric pump and 40 l hotwater, heated also by main engine
- Fresh water tank, appr. 770 l

## ACCESSORIES

- Blinds for hull windows
- Mast steps

## SHIPPING & TRANSPORT

- CE - Certificate cat. A - 12 / B - 16 / C - 20
- Owners manual
- EC - Type Examination Certificate

AS PER STANDARD SPECIFICATION

excl. VAT  
824.900 €

## PACKAGES

### XW2000 Raymarine Navigation Package 20.800 €

XF2000	2 instrument pods (1 per helm station)
XF2200	2 Raymarine i70s multifunction displays in cockpit, incl. transducer (wind/depth/speed/temperature)
XF3000	Raymarine VHF Ray73 at chart table, incl. wireless remote handset
XF4030	2 Raymarine AXIOM2 PRO 9 S chart plotter with HybridTouch multifunction display, 1 per helm station
XF5000	Raymarine Evolution Autopilot with p70s display and wireless remote control
XH2090	Wireless charging at helm station (waterproof)
XK5000	VHF preparation with antenna and splitter for FM and AIS

### XW2002 Upgrade - 12" chart plotter 5.500 €

XF4040	2 Raymarine AXIOM2 PRO 12 S chart plotter with HybridTouch multifunction display, 1 per helm station
XF9001	NMEA Engine information interface for chart plotter (only with chart plotter)

### XW3000 Cruising Package 29.900 €

XC1334	Synthetic teak on helmsman seats (colour selection)
XC9060	2 helmsman seats, foldable
XC9062	Helmsman footrests (free mountable)
XC9080	4 additional cleats, midship, retractable (2 each side)
XC9100	Delta-anchor 40 kg, galvanized with 60 m galvanized chain
XC9402	Cockpit portlight, aft cabins
XE1102	Backstay tensioner, hydraulic
XG3101	Bowthruster, 24 V, retractable, incl. battery
XH1001	Battery set, capacity: 1x 90 Ah + 4x 160 Ah AGM
XH2201	Inverter/charger, incl. AC panel (only with XH1001 or XH1005)
XH5030	Water akku for pressure equalization
XV9420	Wind indicator
XV9450	Flagpole
XV9901	8 fenders
XV9902	4 mooring lines
XV9910	Add. winch handle

XV9950 Hanse maintenance kit

---

**XW3001 Upgrade - Real teak 1.400 €**

XC1325 Real teak on cockpit bottom

XC1333 Real teak on helmsman seats

XC1340 Real teak on cockpit benches

XC1350 Real teak on bathing platform

---

**XW3002 Upgrade - Stainless steel anchor with chain and mooring windlass 5.600 €**

XC9088 Combined mooring/anchor windlass, electrical, 1500 W, automatic fuse, remote control with chain counter (only with XH1001 or XH1005)

XC9101 Delta-anchor 40 kg, stainless steel, with swivel and 100 m stainless steel chain

---

**XW3004 Upgrade - Battery set Lithium 10.500 €**

XH1005 Battery set, capacity: 1x 90 Ah AGM + 4x 200 Ah Lithium

---

**XW4000 Performance Package 13.000 €**

XC2201 2 GRP steering wheels, Y-spoke (black or white)

XE3005 ELVSTRØM SPS performance sails - full battened, triradial, main and jib

XE9001 Dyneema halyards for main and jib

XE9002 Mainsail slider system

---

**XW4100 Gennaker Package 9.100 €**

XE3105 ELVSTRØM Gennaker (colour selection - only with XC9171)

XE3110 Squeezer for Gennaker

XE9003 Gennaker package incl. halyard, 2 sheets, 2 blocks and padeyes (only with XC9171)

---

**XW5000 Comfort Package 14.900 €**

XC9032 Courtesy lights in cockpit

XC9033 Courtesy lights at companionway

XC9040 Exterior Light Signature

XC9051 Electrical deck wash pump, mounted in bow area with outlet on deck

XC9300 2 vents for coach roof hatches

XL9001 Courtesy lights in saloon

XL9003 Indirect lights in saloon and cabins

XL9004 LED overhead lights in saloon and cabins, dimmable



XL9010	SLS - Scenario light system - touch screen controller and dimmer in saloon and fwd cabin
XN2500	Cockpit cushions with backrest (colour selection)
XV9010	Blind set with flyscreens for deck hatches
XV9080	Blinds for side coach roof windows

---

## **XW5500 Fwd Sun Pad Package**

**8.000 €**

XE2030	Sun awning for fwd sun pad, colour: Black, manual
XN2202	Sun pad cushions with storage and cupholder (colour selection)

---

## **XW6000 Flagship Package**

**16.750 €**

XL7003	Design saloon table top, foldable
XL7235	Headboards for aft cabins
XL7240	Slat design in the furniture like design
XL7410	Leather covered handrails
XM1162	Cupboard fronts coloured in High Gloss (selected fronts as per design - colour selection)
XN2055	Luxury upholstery with multifunction backrests
XV9061	Venetian blinds for hull windows

---

## **XW6500 Smart Connection Package**

**3.550 €**

XF4655	Interior camera
XK5031	WLAN router incl. booster antenna

---

## **XW7000 Entertainment Package - Saloon and Cockpit**

**3.750 €**

XK1000	FUSION APOLLO MS-RA770 Multimedia radio with Wi-Fi and touchscreen - for saloon and cockpit (only with XK5000)
XK1200	Subwoofer with amplifier in saloon
XK2040	4 high-end 2-way speakers in saloon
XK2070	2 high-end 2-way speakers in cockpit
XK3000	FUSION MS-ERX400 remote control in cockpit
XK5030	FUSION wireless link - remote control via mobile devices

---

## **XW7010 Entertainment Package - Owner`s cabin**

**4.850 €**

XK1010	FUSION APOLLO MS-RA770 Multimedia radio with Wi-Fi and touchscreen - for master cabin (only with XK5000)
XK2010	2 high-end 2-way speakers in master cabin
XK4010	TV preparation in master cabin (only with B1 or B2 layout)
XK4110	LED TV flat screen in master cabin (only with B1 or B2 layout)

---

<b>XW7030</b>	<b>TV Package - Saloon</b>	<b>4.750 €</b>
XK4040	TV preparation in saloon	
XK4140	LED TV flat screen in saloon	

## OPTIONS

excl. VAT

### HULL

XA1001	GRP hull, gelcoat colour: Grey (similar RAL 7040)	<b>6.900 €</b>
XA1002	GRP hull, painted, non metallic (colour selection)	<b>32.900 €</b>
XA1003	GRP hull, painted, metallic (colour selection)	<b>43.500 €</b>
XA3001	Waterline, coloured gelcoat (colour selection - only with XA1000 or XA1001)	<b>1.000 €</b>
XA3002	Waterline, painted, non metallic (colour selection - only with XA1002 or XA1003)	<b>1.200 €</b>
XA3003	Waterline, painted, metallic (colour selection - only with XA1002 or XA1003)	<b>1.400 €</b>

### KEEL

XB1001	L-keel, cast iron, draft: 2.18 m	<b>5.450 €</b>
XB9000	Keel and rudder - not mounted	<b>1.150 €</b>

### LAYOUT & INTERIOR

XL1002	A2: Crew cabin with storage space, sink and toilet with 60 l black water tank	<b>8.900 €</b>
XL2002	B2: Master cabin with fwd facing island double berth, seating area with vanity table, storage space and ensuite bow head with separated shower	<b>6.950 €</b>
XL2003	B3: 2 fwd cabins with double berth, storage space and separate heads	<b>7.500 €</b>
XL3002	C2: Saloon with full functional island galley and navigation dinette area on port, dining area and multifunction area on stb	<b>2.050 €</b>
XL4002	D2: 2 aft cabins with double berth, storage space and ensuite head with separate shower on stb and utility room on port	<b>2.450 €</b>
XL4003	D3: 2 aft cabins with double berth, storage space and head with separate shower on stb and double bunkbed cabin with storage on port (incl. day head door on stb)	<b>1.750 €</b>
XL6050	Day head door for head in saloon (only with D1 or D2 layout)	<b>1.900 €</b>
XL7001	Saloon table electrically lowerable with cushions, convertible into double berth	<b>5.250 €</b>
XL7051	2 foldable Directors Chair incl. storage room	<b>2.250 €</b>
XL7402	Silent Aft Cabins - cabin noise insulation	<b>600 €</b>
XL7601	Worktop in galley - 'Marine Mineral Stone' (colour selection)	<b>4.000 €</b>



## WOOD (FURNITURE, FLOORBOARD)

XM1102	Furniture - Teak	8.900 €
XM1103	Furniture - Canadian Chestnut	8.900 €
XM1104	Furniture - French Oak	8.900 €
XM1150	Furniture - High Gloss Finish (only with XM1100 or XM1103)	22.500 €
XM1161	Cupboard fronts coloured (selected fronts as per design - colour selection)	2.400 €
XM1201	Floorboard - Classic Stripes	2.400 €
XM1202	Floorboard - Noce Nero	1.550 €
XM1203	Floorboard - Delight Oak	1.550 €

## UPHOLSTERY

XN1100	Comfort mattresses for all berths (excluded A2 and D3 layout)	3.650 €
XN2001	Upholstery - Sorrento (colour selection)	1.950 €
XN2002	Upholstery - Florence (colour selection)	2.500 €
XN2003	Upholstery - Monaco (colour selection)	4.550 €
XN2004	Upholstery - Portofino Leather (colour selection)	8.250 €
XN2400	Sun bed cushions on coach roof (colour selection)	2.600 €
XN2503	Cushion with backrest for helmsman seats (colour selection - only with XC9060)	1.900 €
XN2505	Cushion with backrest for wetbar (colour selection)	600 €

## DECK & OUTSIDE EQUIPMENT

XC1300	Real teak on side deck	27.900 €
XC1301	Synthetic teak on side deck (colour selection)	26.900 €
XC1310	Real teak on coach roof	10.900 €
XC1311	Synthetic teak on coach roof (colour selection)	10.200 €
XC2201	2 GRP steering wheels, Y-spoke (black or white)	2.000 €
XC3004	2 cockpit tables, aluminium foot with teak tops, electrically lowerable into sunbed incl. upholstery	4.750 €
XC3100	Wetbar with BBQ and sink with mixing tap	7.500 €
XC4002	Higher safety railing made of solid stainless steel with integrated side gates	6.200 €
XC5102	2 LEWMAR 65 EST EVO electrical halyard winches with automatic fuse (only with XH1001 or XH1005)	10.000 €
XC5202	2 LEWMAR 65 EST EVO electrical secondary winches with automatic fuse (only with XH1001 or XH1005)	13.550 €
XC6008	Swimming stairs, extractable, manual	3.400 €
XC6502	Gangway, retractable, electric/hydraulic with remote control	29.000 €
XC6601	Stainless steel ladder for gateway exit, foldable	1.150 €

XC7001	Hanse Smart Tender System	9.500 €
XC7010	Beach Club (Inflatable extension of the bathing platform - available from 12/24)	on request
XC7100	Air compressor	950 €
XC9020	Rub rail, teak	2.900 €
XC9032	Courtesy lights in cockpit	400 €
XC9036	LED lights for side decks, integrated in toerail, white	3.650 €
XC9041	4 underwater multicolour lights (red, green, blue and white) below transom	4.850 €
XC9051	Electrical deck wash pump, mounted in bow area with outlet on deck	1.250 €
XC9171	Composite bowsprit with integrated anchor and forestay fitting with double mooring roll incl. 2nd forestay and gennaker eye	2.850 €
XC9404	2 additional sliding hatches, electric driven, next to the companionway	11.500 €

## RIG & SAILS

XE1001	Mast, anodized aluminium with manual inmast furling system (only with XE3001, XE3005 or XE3010)	5.900 €
XE1010	Mast, anodized aluminium with electric inmast furling system (only with XH1001 or XH1005 and XE3001, XE3005 or XE3010)	16.400 €
XE1060	Furling Boom, GRP, painted, colour: black (only with XE1000 and XE3001, XE3005 or XE3010)	on request
XE1121	Vang and backstay tensor, hydraulic bus controlled (only with XE1102)	17.900 €
XE1210	Electric jib furler (only with XH1001 or XH1005)	12.050 €
XE1221	Second forestay with second furler, electrical (only with XH1001 or XH1005 and XC9171)	15.450 €
XE2001	Lazy bag with lazy jacks (colour selection - not with XE1001, XE1010 and XE1060)	1.750 €
XE2009	Canvas windscreen with stainless steel stake (not with XE2010 and XE2012)	4.500 €
XE2010	Fixed windscreen with stainless steel frame (not with XE2009 and XE2012)	8.200 €
XE2012	Sprayhood with stainless steel stake, 3 windows (1 openable - colour selection - not with XE2009 or XE2010 or XE2051 or XE2052 or XE2053)	4.500 €
XE2013	Cockpit canvas cover for GRP hardtop - side and front (colour selection - only with XE2051 or XE2052 or XE2053 and XE2009 or XE2010)	3.650 €
XE2021	Bimini with stainless steel stake (colour selection - not with XE2051, XE2052 and XE2053)	5.700 €
XE2051	GRP hard top for cockpit with canvas sliding roof - outside surface, colour: White	32.050 €
XE2052	GRP hard top for cockpit with canvas sliding roof - outside surface painted, non metallic (colour selection)	38.450 €
XE2053	GRP hard top for cockpit with canvas sliding roof - outside surface painted, metallic (colour selection)	41.100 €
XE2060	Arch/T-Top not mounted	1.150 €
XE3001	ELVSTRØM Blue Water Dacron sails - full battened, main and jib (with XE1001 and XE1010 no battens)	4.200 €
XE3005	ELVSTRØM SPS performance sails - full battened, triradial, main and jib	11.100 €
XE3010	ELVSTRØM HPM high - performance sails, full battened, UV protected membrane, main and jib	22.300 €

XE3024	ELVSTRØM SPS performance sails - for second forestay, vertical battens, triradial, Reacher (only with XE1221 and XC9171)	16.600 €
XE3025	ELVSTRØM HPM high - performance sail - for second forestay, UV protected membrane, Reacher (only with XE1221 and XC9171)	23.700 €
XE9001	Dyneema halyards for main and jib	1.700 €
XE9100	Spreader lights, LED, 6 up and 6 down	4.150 €

## NAVIGATION & INSTRUMENTS

XF4000	Raymarine AXIOM2 PRO 12 S chart plotter with HybridTouch multifunction display at chart table	4.750 €
XF4050	Raymarine AXIOM2 PRO 9 S chart plotter with HybridTouch multifunction display in master cabin (only with B2 layout)	3.550 €
XF4500	Raymarine Quantum 2 Radar (only with chart plotter)	4.050 €
XF4560	MyHanse Safety Cloud hardware with 30 days free trial subscription and an interior light, switchable by APP	1.550 €
XF4600	Raymarine AIS Class B transponder (only with chart plotter and XK5000)	1.650 €
XF4650	Thermal vision camera at mast (only with Navigation Package)	6.700 €
XF4653	SEA.AI Offshore ONE (only with Navigation Package)	12.150 €
XF4701	Raymarine RealVision-3D Sonar (only with chart plotter)	3.050 €
XF5001	2nd redundant autopilot engine (only with XF5000)	2.550 €

## PROPULSION

XG1007	Engine (Diesel, approx. 150 hp) - saildrive, 4-blade folding propeller	12.000 €
XG3201	Sternthruster, 24 V, retractable, incl. battery (only with XG3101)	17.600 €
XG3211	Add. electronic throttle control at helm position, on port	3.550 €

## EQUIPMENT

XH1110	Deep charge protection for service batteries	1.450 €
XH1601	Country Version: US / JPN	3.650 €
XH2080	Solar panel integrated in hard top (only with GRP hard top)	15.750 €
XH2081	Solar panel on coach roof	10.000 €
XH2085	Fuel Cell Pro 2800 BT, max. 125 W	9.400 €
XH2102	Generator 10000i, 8,0 kW / 0 - 9,0 kVA, incl. maintenance kit	24.250 €
XH2103	Generator 15000i, 12,0 kW / 15,0 kVA, incl. maintenance kit	28.250 €
XH2201	Inverter/charger, incl. AC panel (only with XH1001 or XH1005)	3.650 €
XH3011	Electric toilet with sea water flush - cabin layout B1 or B2	1.750 €
XH3013	2 electric toilets with sea water flush - cabin layout B3	3.550 €

XH3021	2 electric toilets with sea water flush - cabin layout D1 or D2	3.550 €
XH3031	Electric toilet with sea water flush - cabin layout D3	1.750 €
XH3200	Freshwater dockside connection in cockpit	700 €
XH4100	Heating, hot water ring with blowers in each cabin and head	15.000 €
XH4511	Air conditioning, 42.000 BTU, 3 units: saloon, fwd cabin, aft cabin, incl. 2nd shore power (recommended with XH2103)	24.400 €
XH4513	Air conditioning, 5.000 BTU, for crew cabin, (only with XH4511 and XL1002)	7.750 €
XH4514	Air conditioning, 5.000 BTU, for D3 layout, (only with XH4511 and XL4003)	7.750 €
XH5020	Water maker, 230 V, 200 l / h (only with XH2102 or XH2103)	25.300 €
XH5100	Additional fridge in multifunction unit (not with XH5101 or XH5112 - only with XH1001 or XH1005)	2.300 €
XH5101	Additional freezer in multifunction unit (not with XH5100 or XH5112 - only with XH1001 or XH1005)	2.300 €
XH5110	Additional fridge in wetbar (only with XC3100)	2.300 €
XH5112	Wine cooler in saloon (not with XH5100 and XH5101 - only with XH1001 or XH1005)	2.850 €
XH5120	Additional freezer in utility room (only with XL4002 and XH1001 or XH1005)	2.300 €
XH5125	Full height fridge/freezer combination instead of the standard fridge	2.900 €
XH5150	Microwave in galley	1.900 €
XH5210	Dishwasher in galley	3.650 €
XH5311	Washing machine with dryer function, front opening, in utility room - cabin layout D2	3.650 €
XH5409	Gas leak detector	1.050 €
XH5410	Additional 2-plate induction hob with pot holding system (only with XH2103)	3.650 €
XH5605	Additional central black water tank, approx. 170 l (only with B1 or B2 layout)	3.190 €
XH6001	Grey water system for bathrooms and galley, tank: 300 l	3.750 €

## RADIO & ENTERTAINMENT

XK1060	FUSION Panel-Stereo - for each aft cabin (only with XK5000)	950 €
XK5000	VHF preparation with antenna and splitter for FM and AIS	500 €

## ACCESSORIES

XV9120	Cockpit table cover (colour selection)	1.050 €
XV9130	Cover for steering wheels (colour selection)	700 €
XV9380	Shrink wrap foil (for storage purpose only / not for transport) (not with XA1002, XA1003, XE2051, XE2052, XE2053, XE2010)	1.200 €

## SHIPPING & TRANSPORT

XZ2001	Loading on truck inclusive transport frame (only with XB9000 and XE2060)	1.500 €
XZ2003	Oversea shipping pack (cradle)	4.750 €
XZ2020	Ready for pickup	700 €

All mentioned prices in €, basic prices ex yard and excl. VAT. All weights and measures are calculated numbers based on the construction data. Changes in construction and equipment reserved.  
Above mentioned prices are recommended for ex yard deliveries within 4 month after order confirmation. For later delivery time the company reserves right to apply latest price list. Company reserves additional 15 working days when painted hull or deck is ordered. All measurements/figures are approximate. Errors and omissions excepted. Specification and material can be changed without notice.  
Valid from 2025.08.01